



BEA

Magic Switch

The Magic Switch, used as a contactless switch, integrates the market safest technology for motion detection: the Doppler effect technology that ensures a high quality of detection.

Product Specification

Technology: Microwave Motion Sensor

Microwave Module: 24.125 GHz

Detection Range (Hand): $\pm 10 - 50$ cm

Detection Mode: Motion (Bidirectional)

Speed fo Target: Min. ± 3 cm/s, Max. 200 Hz or ± 1.2 m/s

Power Supply: DC12 30V, AC12 24V

Current Consumption: < 1.2 W

Output Hold Time: 0.5 Sec. (PULSE mode)

Operating Temp/Humidity: -20° C - $+55^{\circ}$ C

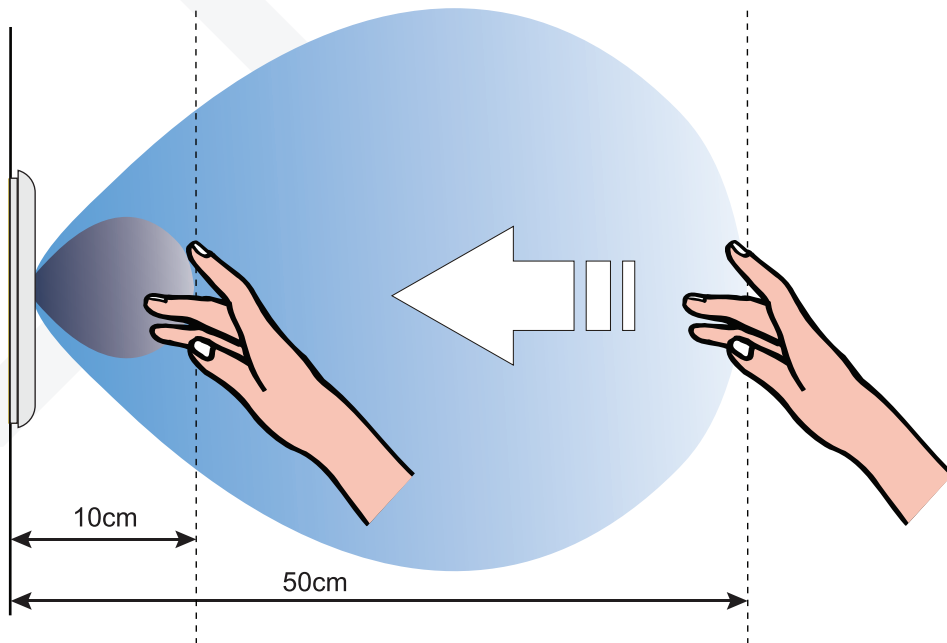

Magic Switch

The sensor can be placed on tiles, wood, plaster, plastic and glass.

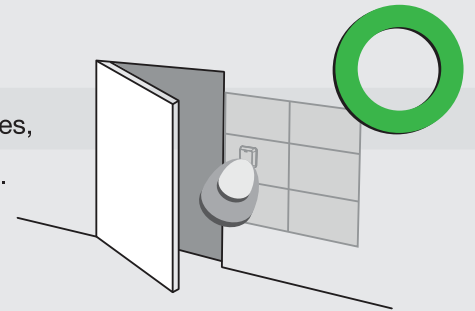

Do not place the sensor behind metallic plates.

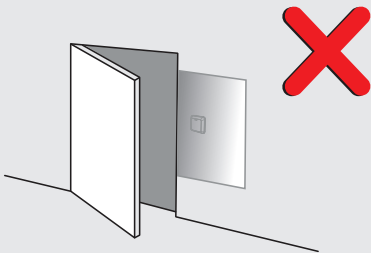

Do not place the sensor in the opening range of the door.

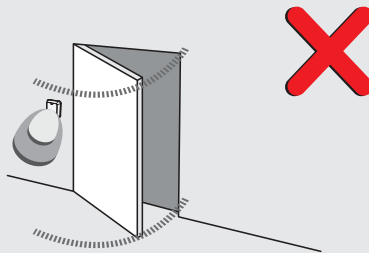

Avoid moving objects in front of the sensor

